



NAGOYA CITY UNIVERSITY

Exchange Program 2026 Spring semester

Fact Sheet

Basic Information

◇Institution

Nagoya City University

◇Campuses and Faculties

Takiko Campus

- Economics
- Humanities and Social Sciences
- Biology and Integrated Sciences
- Data Science



Sakurayama Campus

- Medical School



*Faculty of Medical and Pharmaceutical Sciences don't accept exchange students as a rule.

Kita Chikusa Campus

- Design and Architecture



Tanabe-dori Campus

- Pharmaceutical Sciences



◇International Affairs Office

1 Yamano-hata, Mizuho-cho, Mizuho-ku, Nagoya, JAPAN 467-8501

+81-52-872-6315

◇Contact person

Mio Nagase (Ms.) ryugaku@sec.nagoya-cu.ac.jp

◇Website

<http://www.nagoya-cu.ac.jp/international/index.html>

Academic Information

◇ Semester

Spring Semester : Early April, 2026 ~ Early August, 2026

Fall Semester : Late September, 2026 ~ Early February, 2027

◇ Exchange period

【Spring Semester (1 semester)】 or 【Spring Semester ~ Fall Semester (2 semester)】

*Extension of exchange period will not be permitted after the application deadline.

◇ Website for course syllabus

<https://www.nagoya-cu.ac.jp/english/study/202303/>

<https://www.nagoya-cu.ac.jp/education/guide/syllabus/> (You can search the syllabus (Japanese))

◇ Classes

Classes to be taken at NCU will be determined after the orientation.

Application

◇ Nomination

Deadline: October 1, 2025

-Home university send [nomination sheet] by email to ryugaku@sec.nagoya-cu.ac.jp

◇ Application

Deadline: October 15, 2025

-After the nomination, nominees receive the application link for Exchange Program and Certificate of Eligibility (CoE). It must be completed and submitted to ryugaku@sec.nagoya-cu.ac.jp by the deadline.

*If students don't have google account, please contact ryugaku@sec.nagoya-cu.ac.jp.

-Required documents to be attached.

- Transcript (for the latest year) (Photocopy)
- Photocopy of passport (Photocopy)
- Certificate of Japanese Language levels (Photocopy)
- Color ID photo (Data File)
- CV and portfolio [Graduate school of Design and architecture]

◇ Language Requirement

Bachelor students must prove Japanese language levels when applying.

JLPT N3 or higher is required.

*[Graduate school of Design and Architecture] English acceptable

*[Other Graduate School] please contact ryugaku@sec.nagoya-cu.ac.jp

◇ Japanese language courses

-Japanese Reading/Listening

-Japanese Writing

-Japanese Discussion

-Japanese Presentation

*Japanese language courses are open and credited for all undergraduate students. No credits for graduate students but still available to attend some classes.

NCU Dormitory

◇ Address

2-8 Dankei-Tori Showa-ku Nagoya, 466-0842 JAPAN

* Off campus (10-25 mins to each campus by bicycle)

<http://www.nagoya-cu.ac.jp/international/intl-student/dormitory/index.html>

◇ Expenses

-Rent: ¥25,000 p/m (including water expense and maintenance fee)

- Other expenses: ¥6,000 - ¥8,000 p/m (gas and electricity - depending on use)

◇ Notes

Self-contained private flat, furnished (desk, chair, closet (Japanese style), futon bedding, refrigerator, gas stove, microwave, washing machine, bathroom (toilet and bath), A/C, Wi-fi available.



Exterior view of the dormitory



Japanese-style room



Kitchen

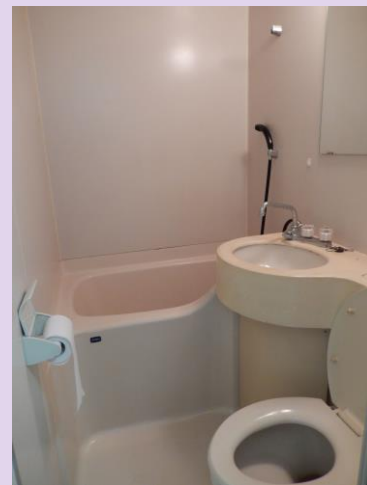

Bathroom

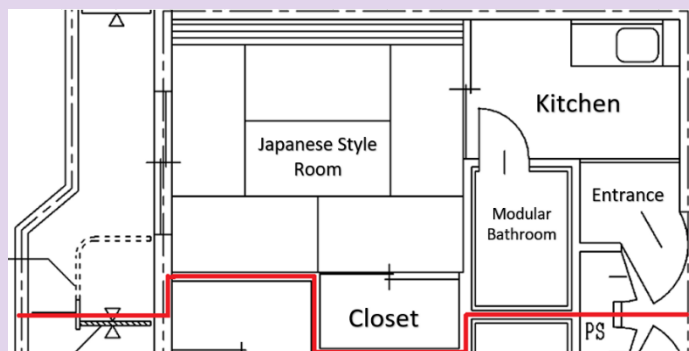

Layout of a room (21.33m²)

An alternative in case NCU Dormitory is not available

International Student Center (Managed and operated by Nagoya International Center)

◇Address

2-29 Koei 2-Chome Minato-ku, Nagoya 455-0015 JAPAN

* Off campus (30 mins by subway to each campus's nearest station)

<https://www.nic-nagoya.or.jp/japanese/international-student-center/>

◇Expenses

-Rent: ¥21,500 p/m (including Internet Facility (No Wi-fi))

-Other expenses; ¥6,000 - ¥8,000 p/m (water and electricity - depending on use)

◇Notes

Furnished room (bathroom, kitchen, air conditioner, bed, Internet, desk, chair, wardrobe, bookshelf, curtains) Futon is provided by NCU.

Other Information

◇Orientation

To be announced.

◇Student tutor

Newly coming exchange student is assigned a Japanese student tutor who helps him/her with the first steps of living/studying in Japan. The student tutor will be arranged before your arrival.

◇Events & Activities

A variety of events below are held on-campus and off-campus in Nagoya City. Exchange students are encouraged to actively participate in the events.

-Picture Book Reading to children at library

-Presentation about students' home countries at elementary/ junior/ high school

-International Students Party etc...

◇Clubs

Exchange students can join NCU sports and culture clubs

◇Japanese classes for international students

Non-credit Japanese language courses are open for international students.

◇Insurance

-All students must have Japan's National Health Insurance (NHI). If you get ill or injured, you pay 30% of medical expenses to receive medical care. The remaining 70% of medical expenses are covered by NHI.

*Insurance premiums (Insurance tax); approximatery 2,000 yen/ month

-All students are required to have adequate accident and health insurance coverage in home country (like as travel insurance etc...).



Picture book reading at local library



Presentation at local school